

This document is the property of Nian-Yeong Corporation and is delivered on the express condition that it is not to be disclosed, reproduced or used, in whole or in part, for manufacture or sale by anyone other than Nian-Yeong Corporation without its prior consent, and that no right is granted to disclose or to use any information in this document.

CUSTOMER DRAWING

REV.	DESCRIPTION	APPROVED BY	DATE	ECN NO.
A	RELEASE	Emily Suen	27/07/11'	
B				
C				

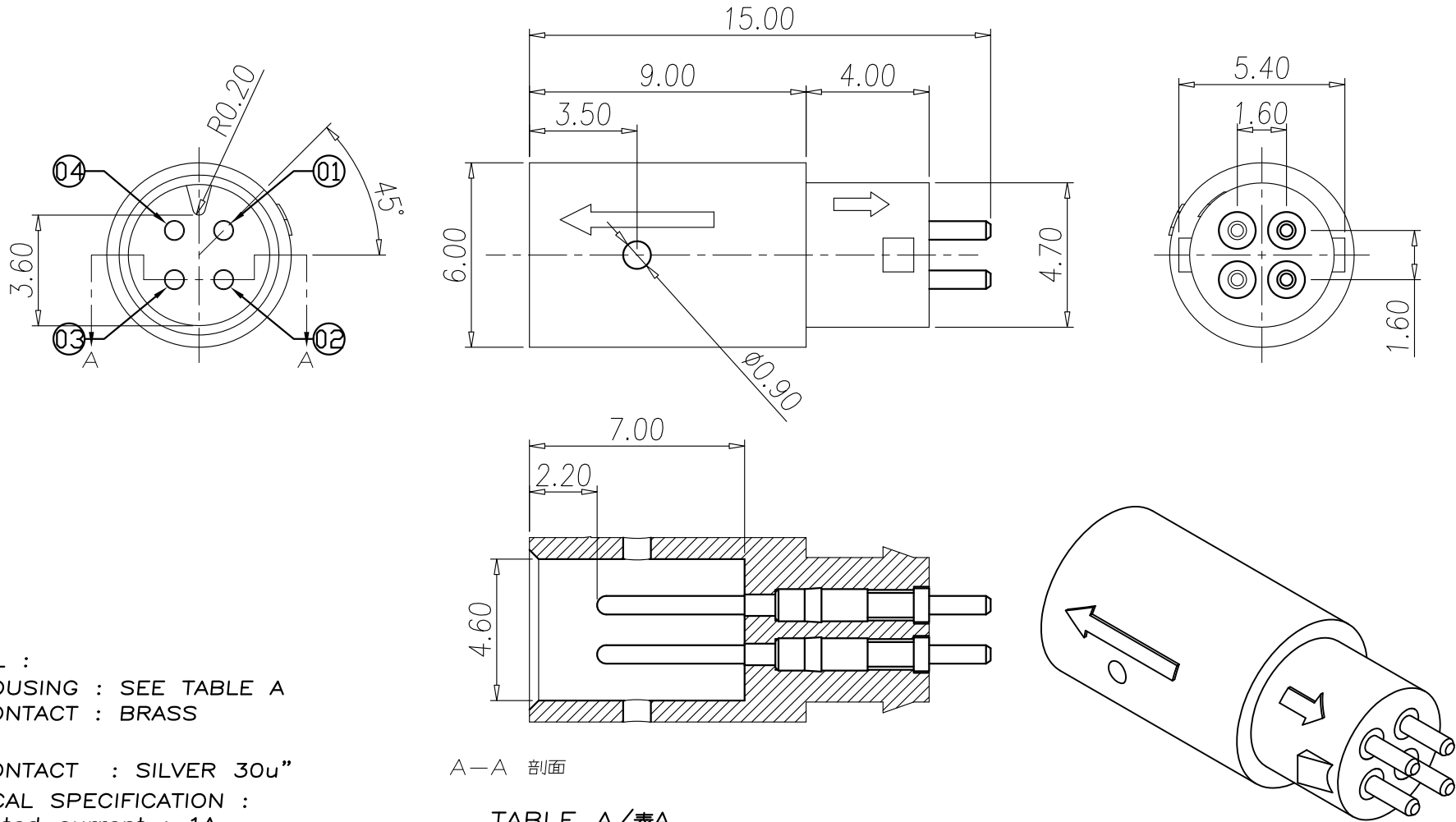

1. MATERIAL :
 - 1-1. HOUSING : SEE TABLE A
 - 1-2. CONTACT : BRASS
2. FINISH :
 - 2-1. CONTACT : SILVER 30u"
3. ELECTRICAL SPECIFICATION :
 - 3-1. Rated current : 1A
 - 3-2. Rated voltage : 30V
4. Environmental :
 - 4-1. Operation Temperature : -20℃~85℃

A-A 剖面

TABLE A/表A

SPD-04M2-02	LCP UL94V-0
SPD-04M2-01	PBT UL94V-0

DRAWN	Sony Cui	APPEND	Emily Suen	UNIT	mm	TOLERANCE		TITLE	特4(M)成形式			SHEET		
CHOKED	Emily Suen			SCALE	1:1	.x ±0.20 .xx ±0.10 .xxx ±0.05 .xxxx ±0.03 ANGULA ±1°			NIAN YEONG ENTERPRISE 年永實業有限公司	PART NO.	SEE TABLE A	DWG NO.	QC5348	1/2 VERSION A

This document is the property of Nian-Yeong Corporation and is delivered on the express condition that it is not to be disclosed, reproduced or used, in whole or in part, for manufacture or sale by anyone other than Nian-Yeong Corporation without its prior consent, and that no right is granted to disclose or to use any information in this document.

CUSTOMER DRAWING

REV.	DESCRIPTION	APPROVED BY	DATE	ECN NO.
A	RELEASE	Emily Suen	27/07/11'	
B				
C				

- 步驟一:
1. 將成品放入PE袋
 2. 每個PE袋裝1000PCS後以熱封機熱封

- 步驟二:
1. 一個紙箱可以裝10個PE袋
 2. 每箱10000pcs.
 3. 將PE袋放紙箱中,後封箱.

- 步驟三:
1. 用膠帶將紙箱封實.
 2. 將標籤貼於紙箱上.

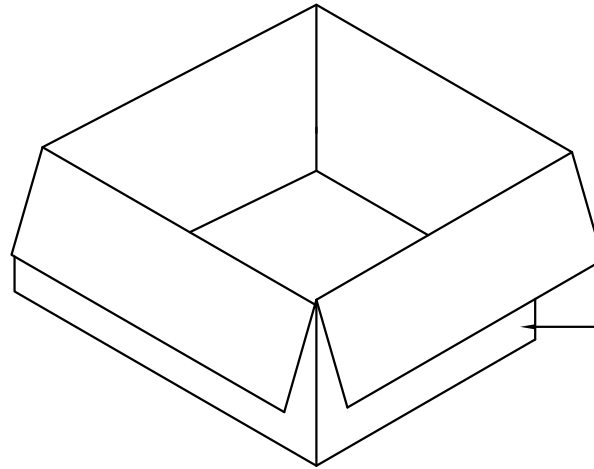
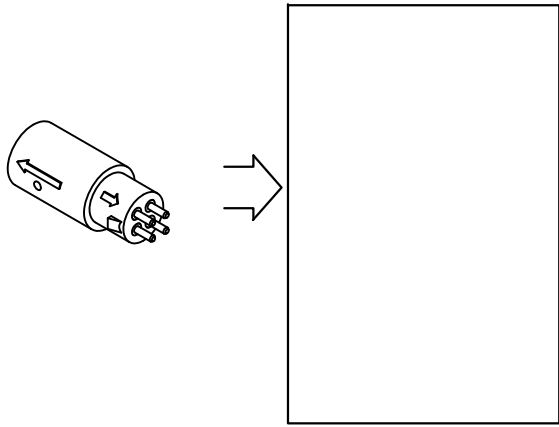

紙箱

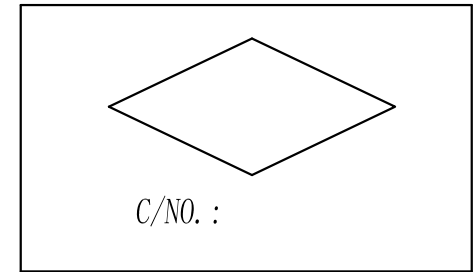
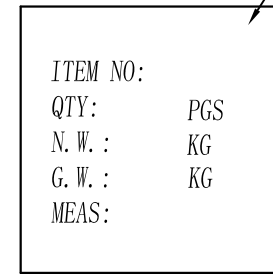

DRAWN	Sony Cui	APP'D	Emily Suen	UNIT	mm	TOLERANCE		TITLE	#4(M)成形式		SHEET	2
CHK'D	Emily Suen			SCALE	1:1	.x ±0.20 .xx ±0.10 .xxx ±0.05 .xxxx ±0.03 ANGULA ±1°		PART NO.	SEE TABLE A	DWG NO.	QC5348	VERSION

NIAN YEONG ENTERPRISE
 年永實業有限公司